

For Lease
±1,403-6,321 SF
Office Space

Coming Soon
NEW
SPEC SUITES

Commerce Point

3511 W Commercial Boulevard
Fort Lauderdale, FL 33309

Property Features

- 24-hour keycard access, newly renovated common areas, abundant natural light, and floor-to-ceiling windows
- Building and monument signage available
- Ample shaded parking
- Separately metered HVAC
- Excellent location in between the Florida Turnpike and I-95
- Easy access to Fort Lauderdale Executive Airport and Cypress Creek business district
- Close to plentiful retail, dining, and banking

Key Highlights



Upgraded common areas, façade update, and new spec suites coming soon!



Close to I-95 and the Florida Turnpike



Close to numerous conveniences and amenities

For more information:

Lesley Sheinberg, Managing Director

lsheinberg@mhcreal.com

C: 561 254 7810 | O: 561 471 8000



FOR LEASE: COMMERCE POINT, FORT LAUDERDALE

±1,403-6,321 SF Office Space Near the Turnpike & I-95



Available Space

Suite 100: 3,302 – 6,231 SF

Suite 101: 2,929 – 6,231 SF

Suite 400: 3,535 SF

Suite 402: 1,403 SF

Rental Rate

\$14.50/SF NNN

\$14.00/SF CAM

Parking

Ample shaded parking
(4/1,000)

**PROPERTY
UPGRADES
COMING SOON**

- Façade update
- New signage
- Lobby renovation
- Elevator cab upgrade complete

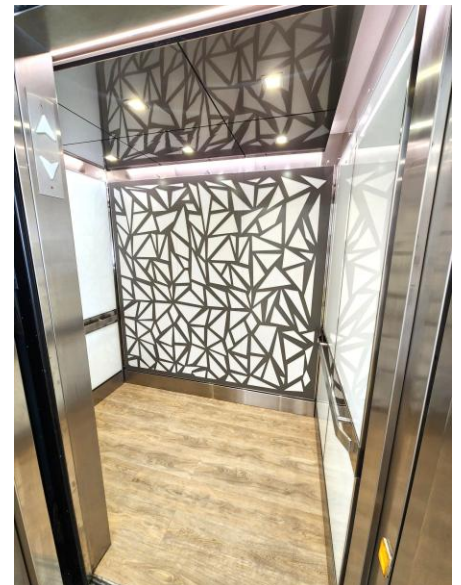

FOR MORE INFORMATION:

Lesley Sheinberg, Managing Director
lsheinberg@mhcreal.com | C: 561 254 7810 | O: 561 471 8000

NO WARRANTY OR REPRESENTATION, EXPRESS OR IMPLIED, IS MADE AS TO THE ACCURACY OF THE INFORMATION CONTAINED HEREIN, AND THE SAME IS SUBMITTED SUBJECT TO ERRORS, OMISSIONS, CHANGE OF PRICE, OR WITHDRAWAL WITHOUT NOTICE.

 561 471 8000

 1601 Forum Place, Suite 700
West Palm Beach, FL 33401

 www.mhcreal.com

BRAND NEW SPEC SUITES

COMING SOON TO COMMERCE POINT

Suite 100 & 101

±2,929-6,231 SF

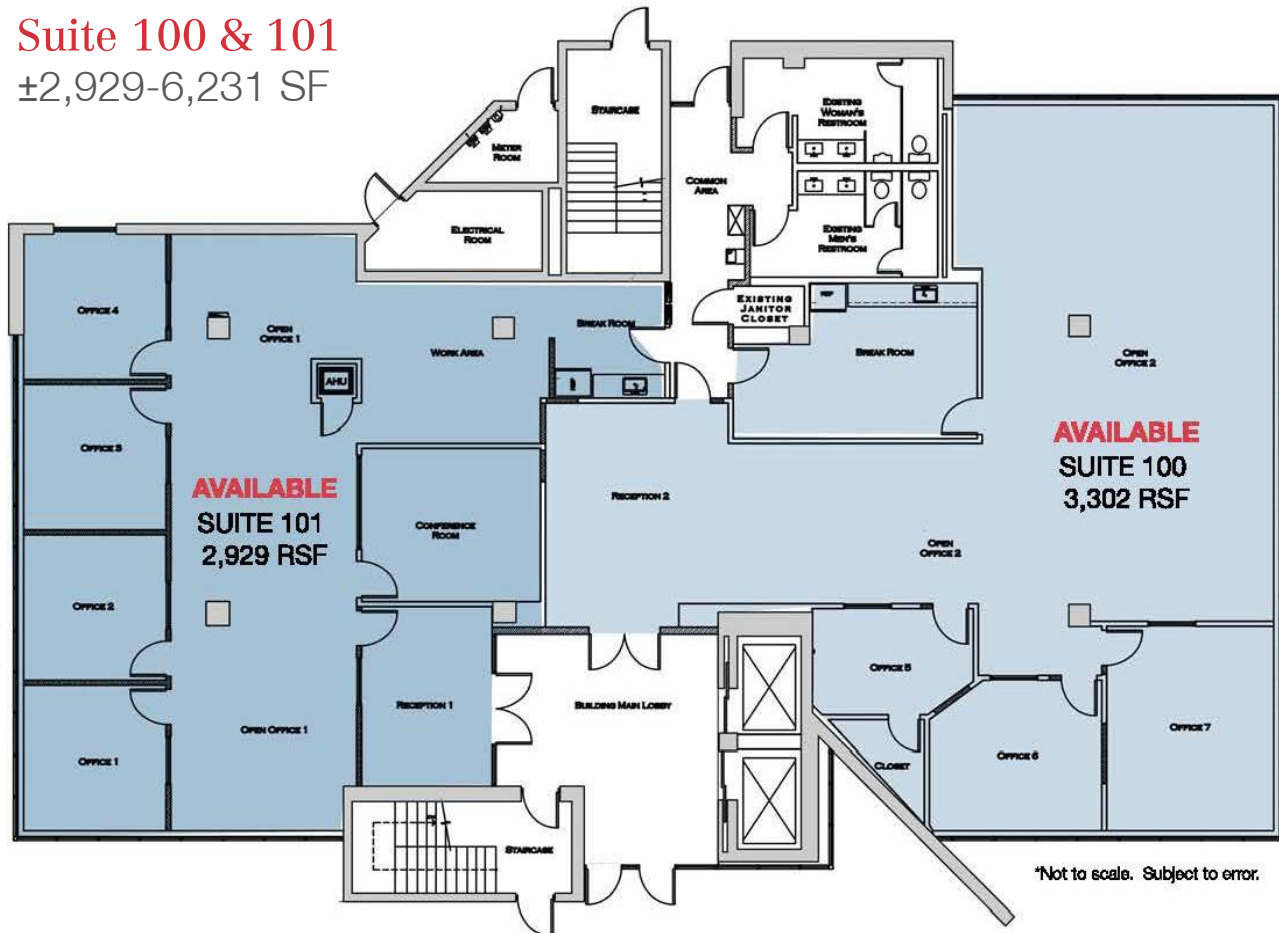

MODERN LAYOUTS



FIRST-FLOOR SUITES



SEAMLESS MOVE-IN

Designed for productivity and comfort, these spaces are perfect for professionals looking to elevate their presence in Fort Lauderdale's dynamic and thriving market.

For More Information:

Lesley Sheinberg | lsheinberg@mhcreal.com



561 471 8000



www.mhcreal.com